



Sample Infant B

8 Children 6wks - 12 months
(Approximately 415 sq feet)

Need to customize? Call 800.777.4244 or
email Sales@CommunityPlaythings.com





Sample Infant B

8 Children 6wks - 12 months
(Approximately 415 sq feet)

Need to customize? Call 800.777.4244 or
email Sales@CommunityPlaythings.com

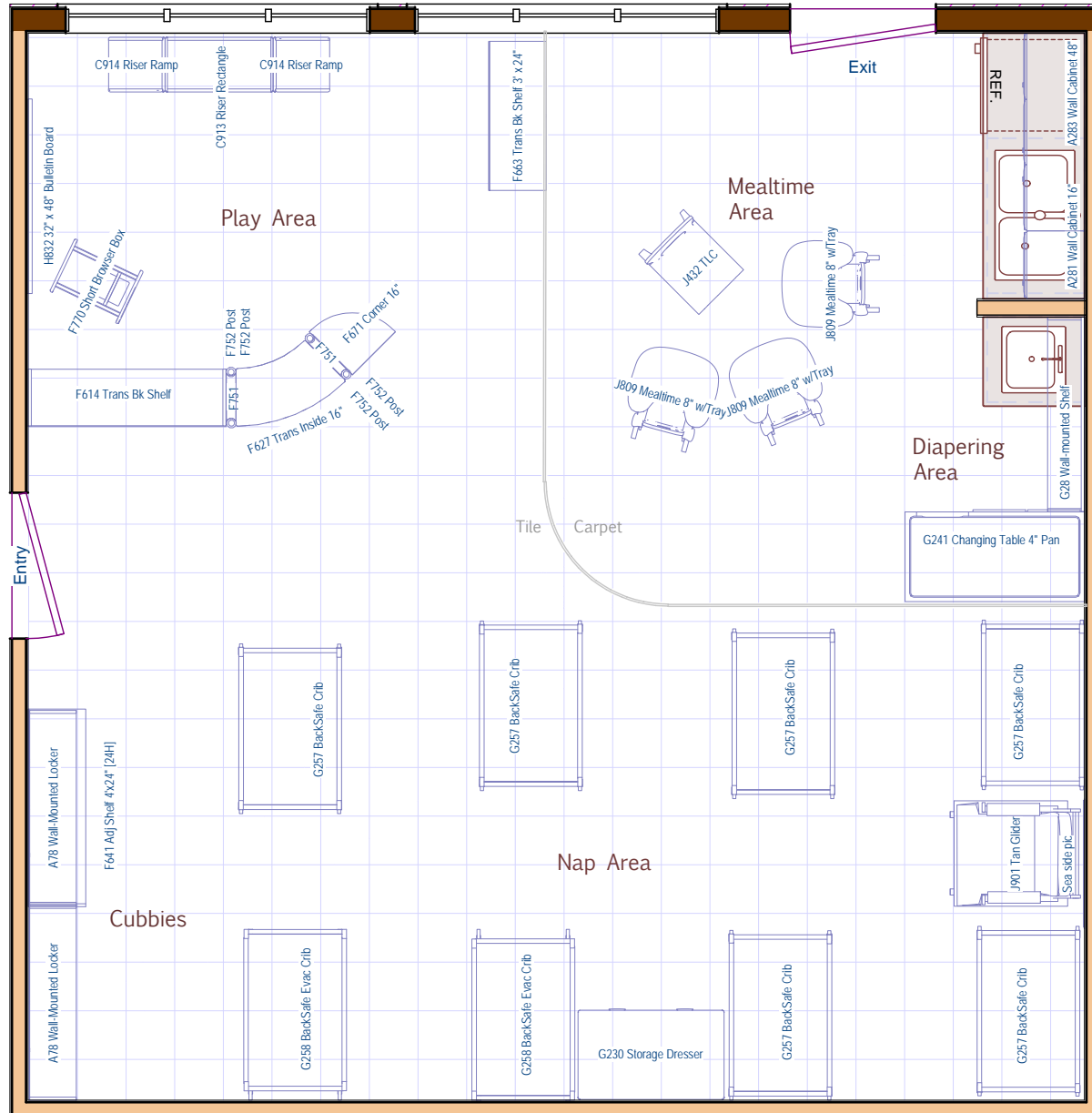



Sample Infant B

8 children, 6 wks-12 months

Pricing intended for budgeting purposes only. Contact Community Playthings for a formal quote.

Item No.	Description	Qty	Price	Ext. Price
A281	Wall-Mounted Cabinet 16"	1	\$255.00	\$255.00
A283	Wall-Mounted Cabinet 48"	1	\$560.00	\$560.00
A78	Wall-Mounted Locker	2	\$175.00	\$350.00
C913	Riser Rectangle	1	\$130.00	\$130.00
C914	Riser Ramp	2	\$100.00	\$200.00
F614	Translucent Back Shelf 4' x 16"	1	\$290.00	\$290.00
F627	Translucent Back Inside Sweep Shelf 16"	1	\$225.00	\$225.00
F641	Adjustable Shelf 4' x 24"	1	\$390.00	\$390.00
F663	Translucent Back Shelf 3' x 24"	1	\$325.00	\$325.00
F671	Corner Shelf 16"	1	\$150.00	\$150.00
F751	Filler	2	\$5.00	\$10.00
F752	Roomscapes Post 16"	4	\$22.00	\$88.00
F770	Small Browser Box	1	\$160.00	\$160.00
G230	Storage Dresser	1	\$950.00	\$950.00
G241	Changing Table with 4" Pan	1	\$1,075.00	\$1,075.00
G257	BackSafe Crib (with Clear View Ends)	6	\$540.00	\$3,240.00
G258	BackSafe Evacuation Crib (with Clear View Ends)	2	\$540.00	\$1,080.00
G28	Wall-mounted Shelf	1	\$360.00	\$360.00
H832	Bulletin Board 32" x 48"	1	\$195.00	\$195.00
J432	Teacher Chair, 12"	1	\$163.00	\$163.00
J809	Mealtime Chair 8" with Tray	3	\$175.00	\$525.00
J901	Community Glider, Tan	1	\$545.00	\$545.00
			Total	\$11,266.00