



# Sample Kindergarten B

24 Children 5-6yrs  
(Approximately 823 sq feet)

Need to customize? Call 800.777.4244 or  
email [Sales@CommunityPlaythings.com](mailto:Sales@CommunityPlaythings.com)





# Sample Kindergarten B

24 Children 5-6yrs  
(Approximately 823 sq feet)

Need to customize? Call 800.777.4244 or  
email Sales@CommunityPlaythings.com

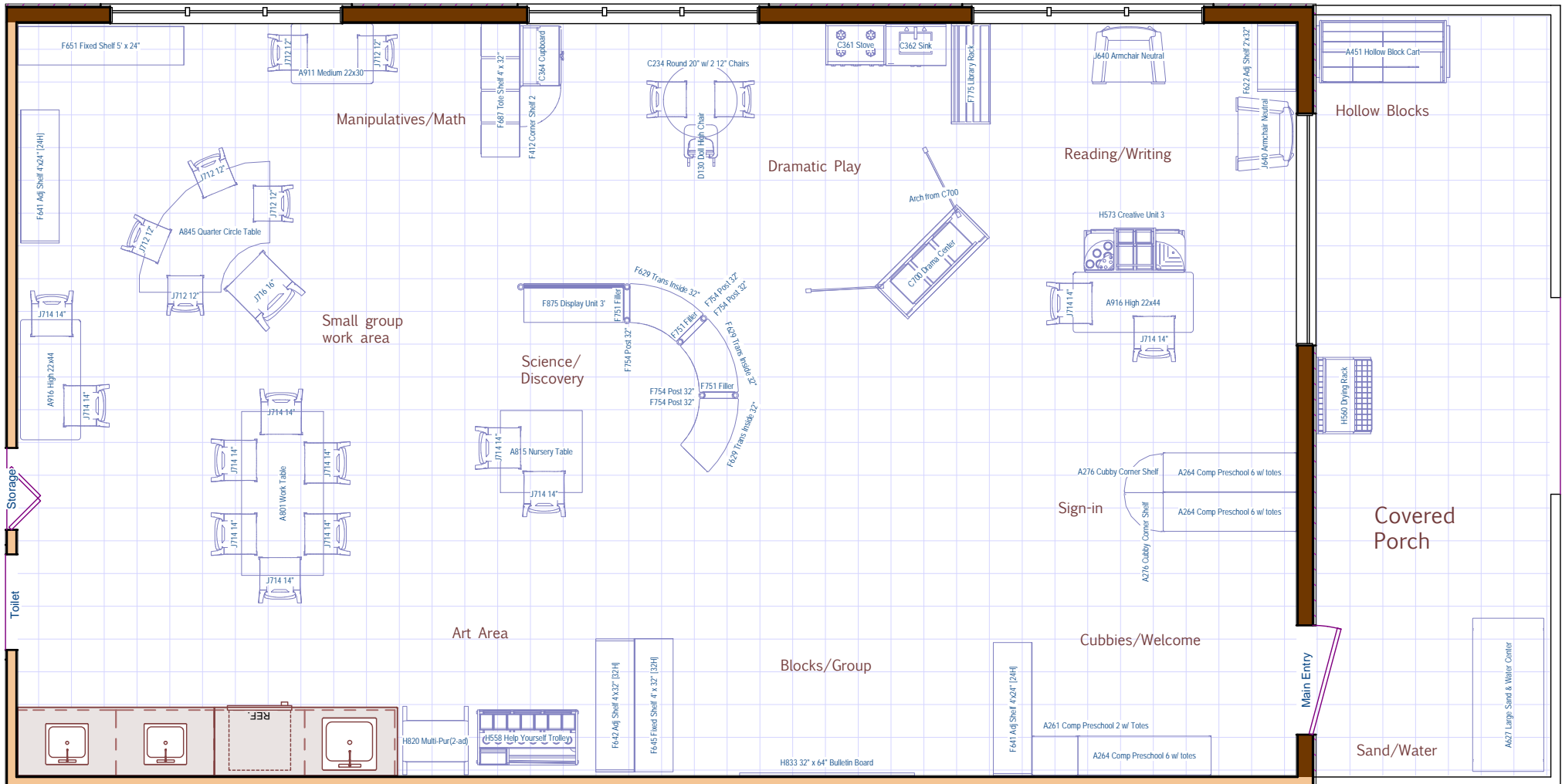



# Sample Kindergarten B

24 children, 5-6 yrs

Pricing intended for budgeting purposes only. Contact Community Playthings for a formal quote.

Item No.	Description	Qty	Price	Ext. Price
A261	Compact Preschool Cubby 2 w/ Compact Totes	1	\$320.00	\$320.00
A264	Compact Preschool Cubby 6 w/ Compact Totes	3	\$780.00	\$2,340.00
A276	Cubby Corner Shelf	2	\$250.00	\$500.00
A451	Hollow Block Cart	1	\$415.00	\$415.00
A627	Large Sand & Water Center	1	\$825.00	\$825.00
A801	Classroom Work Table	1	\$250.00	\$250.00
A815	Classroom Nursery Table	1	\$175.00	\$175.00
A845	Classroom Quarter Circle Table	1	\$315.00	\$315.00
A911	Medium 22" x 30" MultiTable	1	\$180.00	\$180.00
A916	High 22" x 44" MultiTable	2	\$214.00	\$428.00
C234	Round Woodcrest Table 20" and Two Chairs 12"	1	\$405.00	\$405.00
C361	Stove	1	\$260.00	\$260.00
C362	Sink	1	\$240.00	\$240.00
C364	Cupboard	1	\$290.00	\$290.00
C700	Drama Center	1	\$630.00	\$630.00
D130	Doll High Chair	1	\$105.00	\$105.00
F412	Corner Shelf 28", Two Shelves	1	\$220.00	\$220.00
F622	Adjustable Shelf 2' x 32"	1	\$320.00	\$320.00
F629	Translucent Back Inside Sweep Shelf 32"	3	\$370.00	\$1,110.00
F641	Adjustable Shelf 4' x 24"	2	\$390.00	\$780.00
F642	Adjustable Shelf 4' x 32"	1	\$480.00	\$480.00
F645	Fixed Shelf 4' x 32"	1	\$490.00	\$490.00
F651	Fixed Shelf 5' x 24"	1	\$495.00	\$495.00
F687	Tote Shelf 4' x 32"	1	\$705.00	\$705.00
F751	Filler	3	\$5.00	\$15.00
F754	Roomscapes Post 32"	5	\$27.00	\$135.00
F775	Library Rack	1	\$240.00	\$240.00
F875	Display Unit 3' w/ Totes or Baskets	1	\$630.00	\$630.00
H558	Help Yourself Trolley w/ totes or baskets	1	\$575.00	\$575.00
H560	Drying Rack	1	\$510.00	\$510.00
H573	Creative Unit 3 w/ totes or baskets	1	\$740.00	\$740.00
H820	Multi-purpose Easel	1	\$340.00	\$340.00
H833	Bulletin Board 32" x 64"	1	\$325.00	\$325.00
J640	Child's Armchair, Neutral	2	\$310.00	\$620.00
J712	Woodcrest Chair 12"	6	\$100.00	\$600.00
J714	Woodcrest Chair 14"	12	\$108.00	\$1,296.00
J716	Woodcrest Chair 16"	1	\$140.00	\$140.00
			<b>Total</b>	<b>\$18,444.00</b>