



Sample Montessori Toddler A

12 Children 18-36 months
(Approximately 448 sq feet)

Need to customize? Call 800.777.4244 or
email Sales@CommunityPlaythings.com





Sample Montessori Toddler A

12 Children 18-36 months
(Approximately 448 sq feet)

Need to customize? Call 800.777.4244 or
email Sales@CommunityPlaythings.com

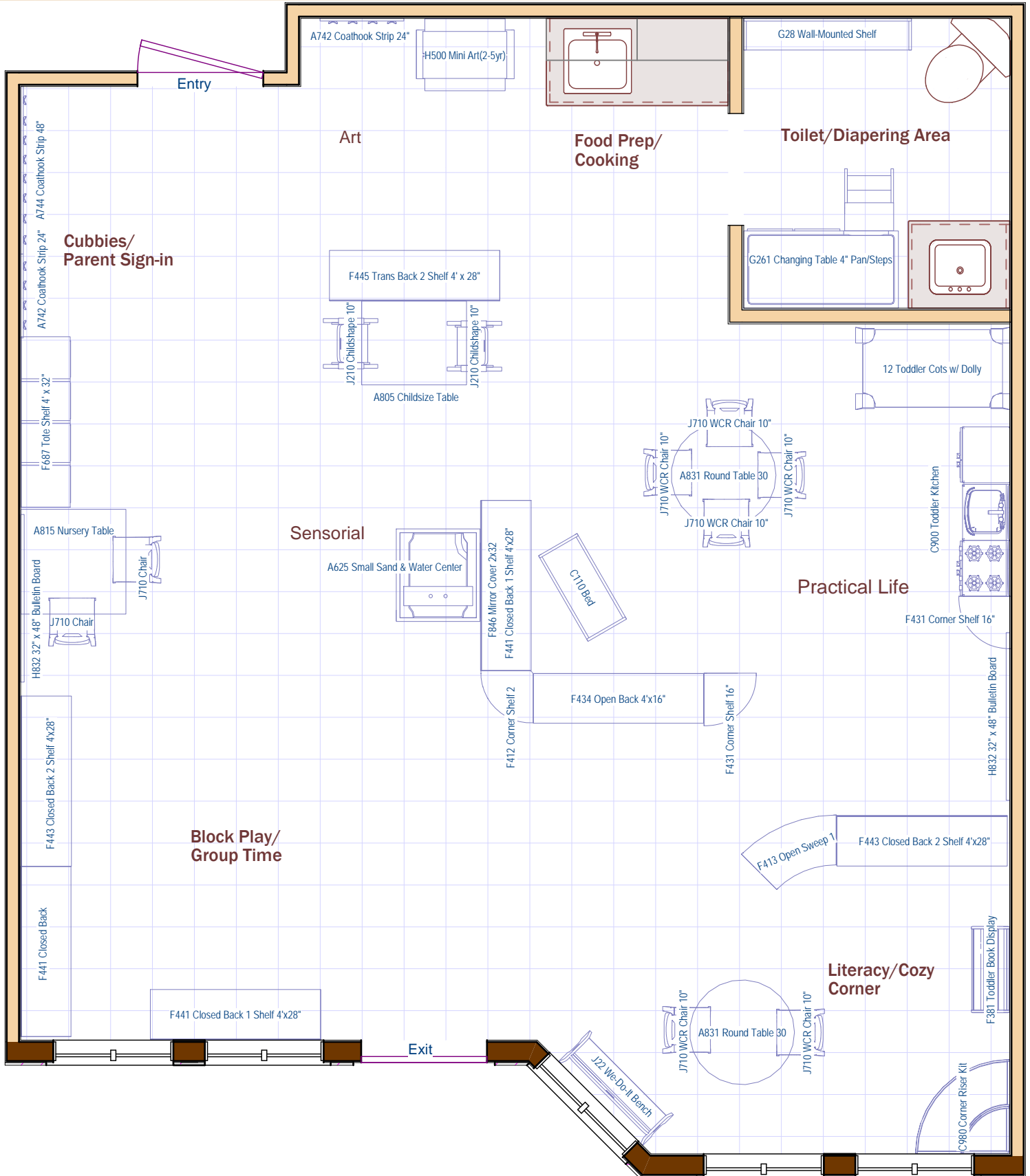



Sample Montessori Toddler

12 children, 18-36 months

Pricing intended for budgeting purposes only. Contact Community Playthings for a formal quote.

Item No.	Description	Qty	Price	Ext. Price
A625	Small Sand & Water Center	1	\$425.00	\$425.00
A742	Coathook Strip 24"	2	\$37.00	\$74.00
A744	Coathook Strip 48"	1	\$67.00	\$67.00
A805	Classroom Childsize Table	1	\$170.00	\$170.00
A815	Classroom Nursery Table	1	\$175.00	\$175.00
A831	Classroom Round Table 30	2	\$185.00	\$370.00
C110	Bed	1	\$120.00	\$120.00
C900	Toddler Kitchen	1	\$640.00	\$640.00
C980	Corner Riser Kit	1	\$385.00	\$385.00
F381	Toddler Book Display	1	\$190.00	\$190.00
F412	Corner Shelf 28", Two Shelves	1	\$220.00	\$220.00
F413	Open Sweep Shelf 28", One Shelf	1	\$290.00	\$290.00
F431	Corner Shelf 16"	2	\$140.00	\$280.00
F434	Open Back Shelf 4' x 16"	1	\$255.00	\$255.00
F441	Closed Back Shelf 4' x 28", One Shelf	1	\$375.00	\$375.00
F441	Closed Back Shelf 4' x 28", One Shelf	2	\$375.00	\$750.00
F443	Closed Back Shelf 4' x 28", Two Shelves	2	\$440.00	\$880.00
F445	Translucent Back Shelf 4' x 28", Two Shelves	1	\$440.00	\$440.00
F687	Tote Shelf 4' x 32"	1	\$705.00	\$705.00
F846	Mirror Cover for Shelf or Panel	1	\$86.00	\$86.00
G261	Changing Table with steps and 4" Pan	1	\$1,340.00	\$1,340.00
G28	Wall-mounted Shelf	1	\$360.00	\$360.00
H500	Mini Art Island	1	\$550.00	\$550.00
H832	Bulletin Board 32" x 48"	2	\$195.00	\$390.00
J22	We-Do-It Bench	1	\$87.00	\$87.00
J210	Childshape Chair 10"	2	\$74.00	\$148.00
J710	Woodcrest Chair 10"	8	\$89.00	\$712.00
M161	Toddler Cot	11	\$60.00	\$660.00
M171	Toddler Cot Dolly	1	\$70.00	\$70.00
			Total	\$11,214.00