



# Sample Toddler A

8 Children 12-18 Months  
(Approximately 380 sq feet)

Need to customize? Call 800.777.4244 or  
email [Sales@CommunityPlaythings.com](mailto:Sales@CommunityPlaythings.com)





# Sample Toddler A

8 Children 12-18 Months  
(Approximately 380 sq feet)

Need to customize? Call 800.777.4244 or  
email Sales@CommunityPlaythings.com

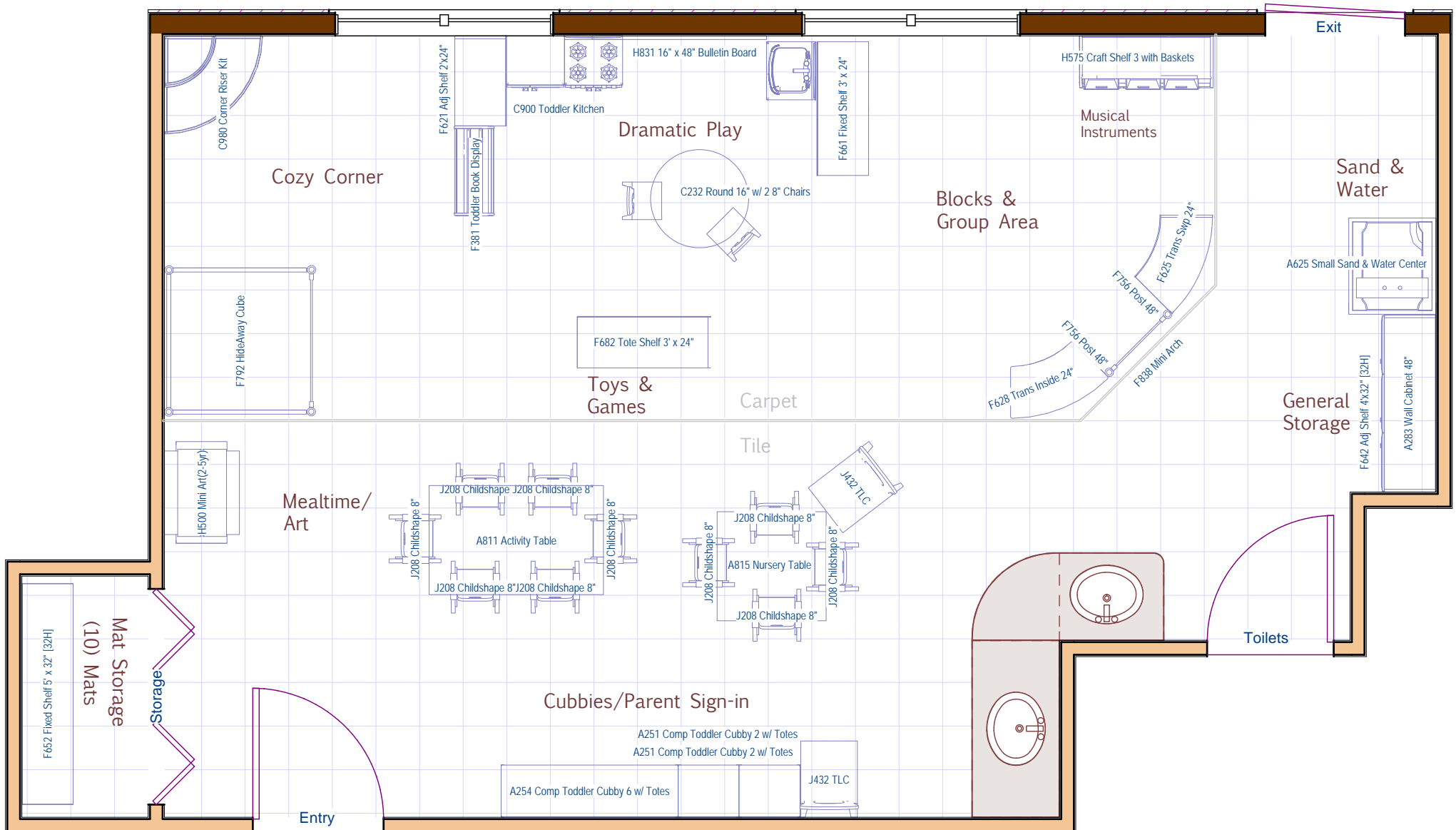



## Sample Toddler A

10 children, 12-18 months • 2 Caregivers

Pricing intended for budgeting purposes only. Contact Community Playthings for a formal quote.

Item No.	Description	Qty	Price	Ext. Price
A251	Compact Toddler Cubby 2 w/ Compact Totes	2	\$275.00	\$550.00
A254	Compact Toddler Cubby 6 w/ Compact Totes	1	\$670.00	\$670.00
A283	Wall-Mounted Cabinet 48"	1	\$560.00	\$560.00
A625	Small Sand & Water Center	1	\$425.00	\$425.00
A811	Classroom Activity Table	1	\$230.00	\$230.00
A815	Classroom Nursery Table	1	\$175.00	\$175.00
C232	Round Woodcrest Table 16" and Two Chairs 8"	1	\$385.00	\$385.00
C900	Toddler Kitchen	1	\$640.00	\$640.00
C980	Corner Riser Kit	1	\$385.00	\$385.00
F381	Toddler Book Display	1	\$190.00	\$190.00
F621	Adjustable Shelf 2' x 24"	1	\$265.00	\$265.00
F625	Translucent Back Sweep Shelf 24"	1	\$275.00	\$275.00
F628	Translucent Back Inside Sweep Shelf 24"	1	\$290.00	\$290.00
F642	Adjustable Shelf 4' x 32"	1	\$480.00	\$480.00
F652	Fixed Shelf 5' x 32"	1	\$610.00	\$610.00
F661	Fixed Shelf 3' x 24"	1	\$325.00	\$325.00
F682	Tote Shelf 3' x 24"	1	\$435.00	\$435.00
F756	Roomscapes Post 48"	2	\$36.00	\$72.00
F792	HideAway Cube	1	\$660.00	\$660.00
F838	Mini Arch	1	\$63.00	\$63.00
H500	Mini Art Island	1	\$550.00	\$550.00
H575	Craft Shelf 3 w/ totes or baskets	1	\$300.00	\$300.00
H831	Bulletin Board 16" x 48"	1	\$135.00	\$135.00
J208	Childshape Chair 8"	10	\$72.00	\$720.00
J432	Teacher Chair, 12"	2	\$163.00	\$326.00
M65	Rest Mat	10	\$43.00	\$430.00
			<b>Total</b>	<b>\$10,146.00</b>